

Ballrooms

Situated off of our expansive pre-function Galleria space, the Baton Rouge River Center Ballrooms are the perfect venue to host your tradeshow, speaking engagement, banquet or meeting.

LEGEND

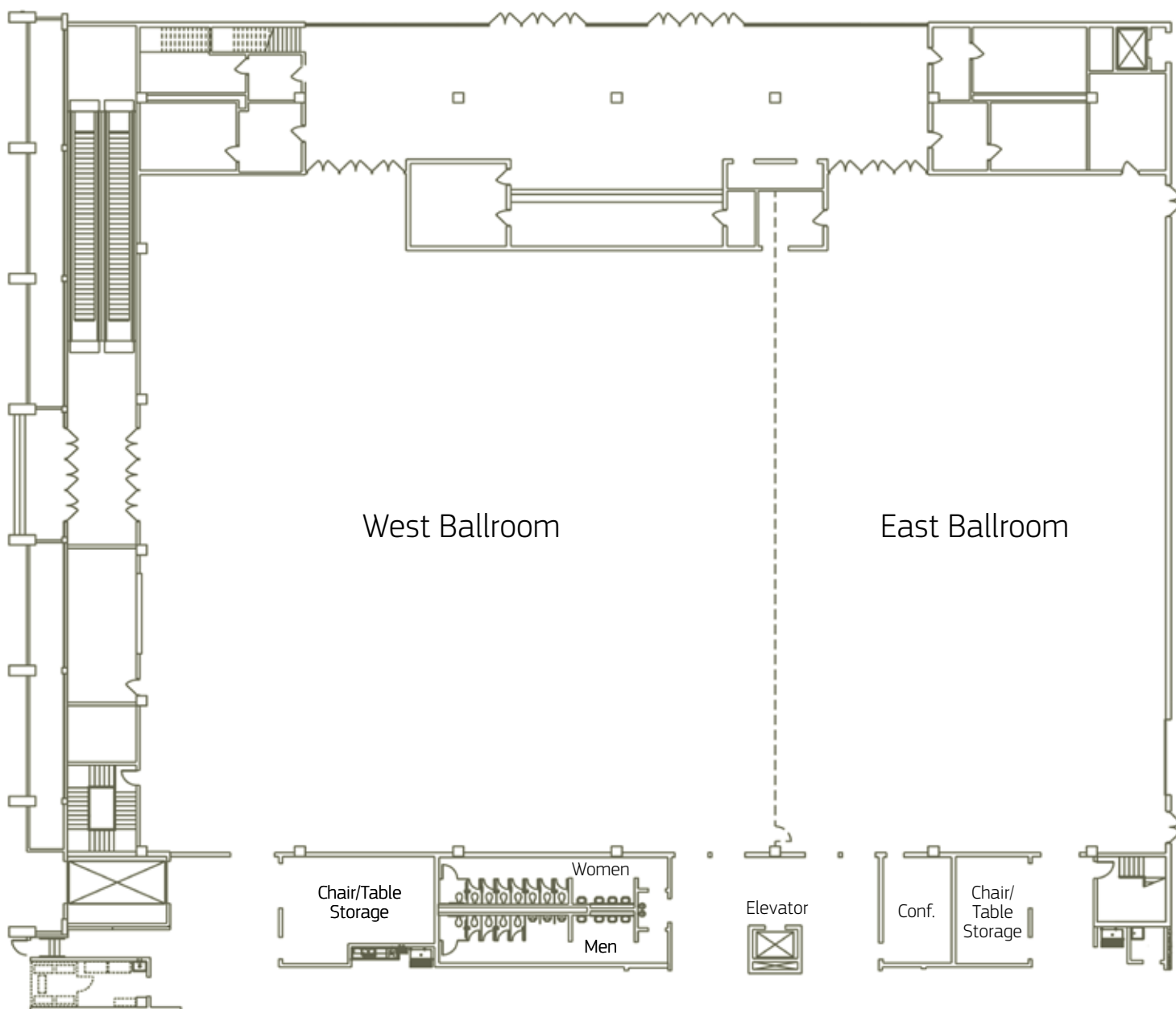

Ballrooms

CAPACITY INFORMATION

BALLROOMS 1ST. FLOOR	CEILING HEIGHT	GROSS SQ. FEET	CLASSROOM 30" TABLES	THEATRE	BANQUET 72" ROUNDS	RECEPTION	DIMENSION
Ballroom 1 (West)	25'	16,083	-	1072	750	-	116 x 119
Ballroom 2 (East)	25'	10,253	-	685	450	-	71 x 119
Ballroom 1 & 2	25'	26,336	-	1,757	1,200	-	119.10 x 193.10
L1	18'	1,650	72	186	60	96	28.2 x 46.5
L2	18'	950	48	121	30	64	20.3 x 46.5
L3	18'	1,430	72	90	60	96	32.8 x 44.5
L4	18'	1,166	72	80	60	96	26.9 x 44.5
L3 & L4	18'	2,596	144	170	110	184	59.5 x 44.5

BALLROOM CAPACITY

- Ballroom with total of approx. 26,000 sq. ft.
- Hall can be divided into two separate areas; 16,000 sq. ft./10,000 sq. ft.

SUPPORT SPACE

- Pre-function lobby space available with ticketing area
- Galleria – Adjacent to ballroom, total approx. 27,000 sq. ft. and serves as a function space for meals, receptions, exhibits, registration, etc...

BALLROOM UTILITIES

- Wireless
- Secure reliable computing environment
- Tailorable portal redirection to accent your event
- Portability throughout our venues

BALLROOM AMENITIES

- Roll door for easy load in and out on same level
- Freight Elevator accessibility from loading dock



*Worldwide Entertainment and
Convention Venue Management*